



Positive Displacement Blowers^W



High Performance, High Efficiency

Designed For Peak Performance.

Two Year Manufacturer's Warranty



Heavy Duty Construction

Kice Blowers start with heavy, cast iron bodies and rotors. The quality of the castings used is guaranteed because we own the foundry, CFM Corporation, that supplies the castings.

Sanitary Housing

Our unique rotor tip design reduces slip by 5-13% as compared to other blowers on the market. The lower slip factors allow Kice Blowers to run 30-40 degrees cooler than other blowers. This, along with oversized oil reservoirs, eliminates the need for cooling ribs on the exterior of the body. The result is a perfectly smooth external geometry which makes the Kice Blower the cleanest available.

Oversized Shaft

The Kice Blower comes with an oversized shaft that reduces the chance of shafts being broken or damaged from overtensioning of belts.

Quiet, Low Speed Operation

While the Kice Blower is perfectly suited to run over 3000 rpm, it is designed to operate much slower. The slower speed increases expected bearing life (150,000 hours) and reduces noise levels significantly.

Oversized, Extra Bearings

Kice Blowers have a fifth outboard bearing on the drive side of the blower. The extra bearing reduces the torsional load on the rotors and internal bearings. Internal bearings are oversized like everything else on this blower. Expected bearing life is 150,000 hours which is 50-100% higher than other blowers on the market.

Unmatched Efficiency

Unlike most blowers, the Kice Blower has its gears on the drive side. This provides a more even split of power between the two rotors. This, along with the lower slip factors, makes the Kice Blower the most efficient blower available in terms of CFM/PSIG/HP.

Dimension Specifications

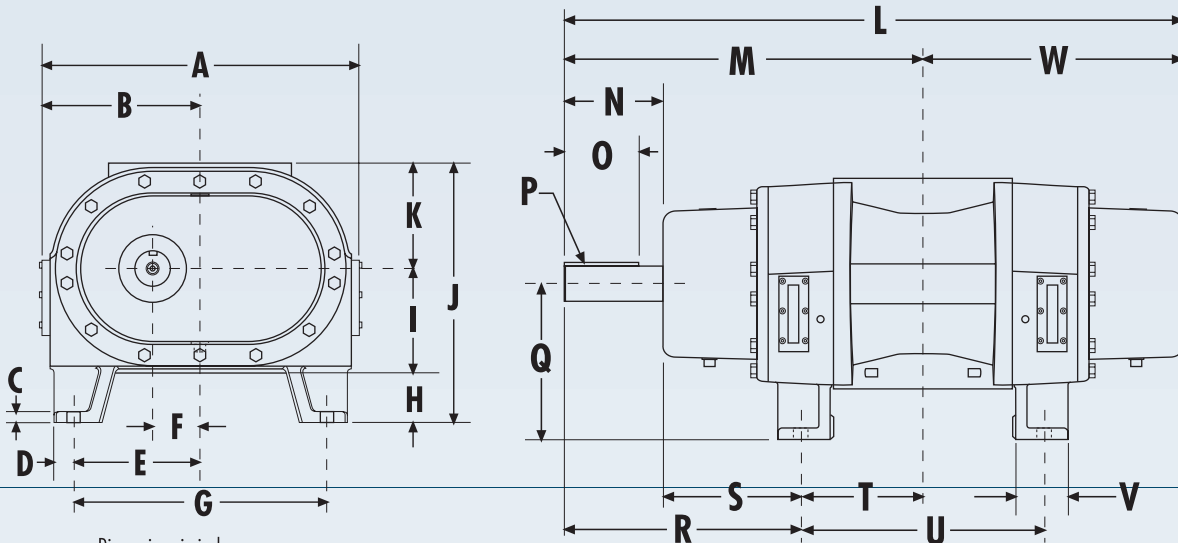

Dimensions in inches

MODEL	A	B	C	D	E	F	G	H	I	J	K
PDF 2000*	11 1/16	5 9/16	3/8	9/16	4 1/2	1 5/8	9	1 15/16	3 9/16	9 7/8	4 3/8
PDF 2500*	11 1/16	5 9/16	3/8	9/16	4 1/2	1 5/8	9	1 15/16	3 9/16	9 7/8	4 3/8
PD 3000	15 5/8	7 13/16	9/16	1	6 1/4	2 5/16	12 1/2	2 1/2	5 1/4	13	5 1/4
PD 4000	15 5/8	7 13/16	9/16	1	6 1/4	2 5/16	12 1/2	2 1/2	5 1/4	13	5 1/4
PD 5000	19 1/8	9 9/16	3/4	1 1/8	8	3	16	4 1/4	6 1/2	17 1/4	6 1/2
PD 6000	19 1/8	9 9/16	3/4	1 1/8	8	3	16	4 1/4	6 1/2	17 1/4	6 1/2

Dimensions in inches

MODEL	L	M	N	O	P	Q	R	S	T	U	V	W
PDF 2000*	21 9/16	11 15/16	2 7/16	1 3/4	.9375	5 1/2	8 15/16	6 1/2	3	6	2 3/8	9 5/8
PDF 2500*	24 9/16	13 7/16	2 7/16	1 3/4	.9375	5 1/2	8 15/16	6 1/2	4 1/2	9	2 3/8	11 1/8
PD 3000	27 5/16	16 3/16	5	3 3/4	1.7495	7 3/4	11 7/8	6 3/4	4 5/16	8 5/8	2 9/16	11 1/8
PD 4000	30 3/4	17 15/16	5	3 3/4	1.7495	7 3/4	11 7/8	6 3/4	6 1/16	12 1/8	2 9/16	12 7/8
PD 5000	31 3/4	18 5/16	5 1/16	3	1.9950	10 3/4	12 3/16	7 1/8	6 1/16	12 1/8	3	13 7/16
PD 6000	35 3/4	20 5/16	5 1/16	3	1.9950	10 3/4	12 3/16	7 1/8	8 1/16	16 3/16	3	15 7/16

*Filter Blower Models

PDF 2000 is 2" NPT

PDF 2500 is 3" NPT

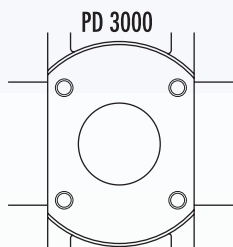

PD 3000
5/8-11UNC-2B X .56 DP
4 HOLES EACH SIDE
6.0" BC 350 LBS

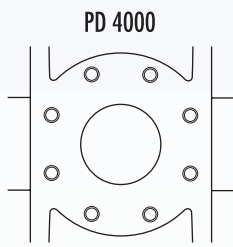

PD 4000
5/8-11UNC-2B X .56 DP
8 HOLES EACH SIDE
7.5" BC 420 LBS

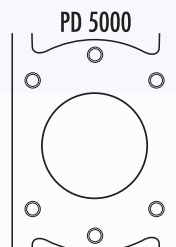

PD 5000
5/8-11UNC-2B X .83 DP
6 HOLES EACH SIDE
8.5" BC 650 LBS

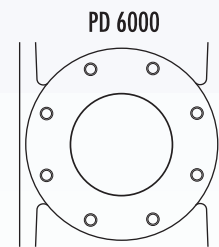

PD 6000
5/8-11UNC-2B X .83 DP
8 HOLES EACH SIDE
9.5" BC 750 LBS

NOTE: REFER TO CURRENT MAINTENANCE MANUAL FOR SERVICE INSTRUCTIONS.

Kice Filter Blowers,

Engineered Specifically For Baghouse Filters.

Through years of filter and blower experience, we've designed a blower with the ability to stand up to the wide range of operating pressures typical with baghouse filter applications. You can count on the superior performance and durability this blower offers.

- Severe-duty construction for maximum life.
- Operates in a wide range of air volumes, 40 CFM to 160 CFM.
- Oversized bearings and shafts withstand heavy loads.
- Extra drive bearing for higher load ratings.
- Cast ductile iron rotors, cast iron bodies provide a tough foundation.
- Oversized oil reservoirs for cool, quiet running.
- Smooth, ribless body makes sanitation easy.

It's simply the best blower you can buy for your old or new filter system.



Kice Blowers are available for your existing systems and as part of complete Kice Air Power Units.



KICE INDUSTRIES, INC.

5500 N. Mill Heights Drive
Wichita, KS 67219
TEL: (316) 744-7151 FAX: (316) 744-7355
QUIKSHIP CENTER: 1-877-289-5423 quikship@kice.com
e-mail: sales@kice.com web site: www.kice.com