

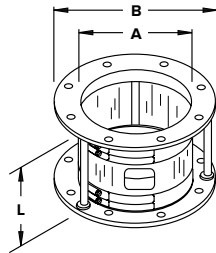

Series 71/72/73 Sight Glasses

Series 70 Kice Sight Glasses are available in flanged and Tube OD. Available from stock in Aluminum or Steel. Stainless Steel available on special order. Additional sizes, designs, and gauges available upon request.

#71-2 ROUND-TO-ROUND FLANGED SIGHT GLASS



| PART NO. | SIZE | A (ID) | B (OD) | L |
|----------|------|--------|--------|---|
| 71A6-2 | 6 | 5.5 | 9 | 6 |
| 71A8-2 | 8 | 7.5 | 11 | 6 |
| 71A10-2 | 10 | 9.5 | 13 | 6 |
| 71A12-2 | 12 | 11.5 | 15 | 6 |
| 71A14-2 | 14 | 13.5 | 17.25 | 6 |
| 71A15-2 | 15 | 14.5 | 18.25 | 6 |

#71-3 ROUND-TO-SQUARE FLANGED SIGHT GLASS

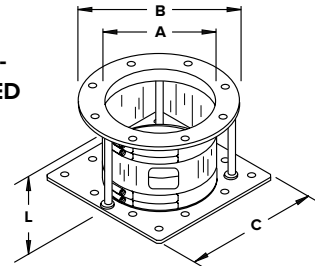

| PART NO. | SIZE | A (ID) | B (OD) | L | C |
|----------|------|--------|--------|---|-------|
| 71A6-3 | 6 | 5.5 | 9 | 6 | 9 |
| 71A8-3 | 8 | 7.5 | 11 | 6 | 11 |
| 71A10-3 | 10 | 9.5 | 13 | 6 | 13.25 |
| 71A12-3 | 12 | 11.5 | 15 | 6 | 15.25 |
| 71A14-3 | 14 | 13.5 | 17.25 | 6 | 17.25 |
| 71A15-3 | 15 | 14.5 | 18.25 | 6 | 18.25 |

"-2" specifies Round-to-Round Sight Glass and "-3" specifies Round-to-Square Sight Glass. Sight Glass flange patterns shown on Speed Spout Technical Manual - Page 47. "A" in part number specifies Aluminum material. Specify "B" for Steel and "S" for 304L Stainless Steel. Series 71 Sight Glass assemblies rated to 15 PSIG and 15 in. Hg. 2" thru 6"OD size uses Polycarbonate tubing and is rated to 240°F; 8" and larger use Acrylic tubing and are rated to 150°F. For 4" long Series 71 Sight Glass replacement tube, specify PN 73P(Size)-4. For replacement Neoprene Garter, specify "Garter for (Size) Sight Glass." For replacement Band Clamp, specify "Band/Clamp Assembly for (Size) Sight Glass"

#72 TUBE OD SIGHT GLASS

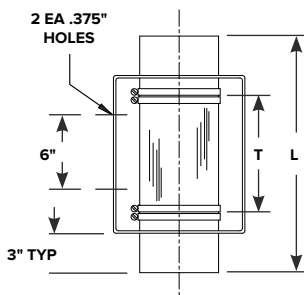
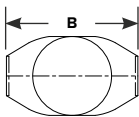

| PART NO. | D (OD) | L | T | B |
|----------|--------|----|---|------|
| 72A2 | 2 | 18 | 9 | 5.5 |
| 72A2.5 | 2.5 | 18 | 9 | 6 |
| 72A3 | 3 | 18 | 9 | 6.5 |
| 72A3.5 | 3.5 | 18 | 9 | 7 |
| 72A4 | 4 | 18 | 9 | 7.5 |
| 72A4.5 | 4.5 | 18 | 9 | 8 |
| 72A5 | 5 | 18 | 9 | 8.5 |
| 72A6 | 6 | 18 | 9 | 9.5 |
| 72A7 | 7 | 18 | 9 | 10 |
| 72A8 | 8 | 18 | 9 | 10.5 |
| 72A10 | 10 | 18 | 9 | 12.5 |
| 72A12 | 12 | 18 | 9 | 14.5 |
| 72A14 | 14 | 18 | 9 | 16.5 |
| 72A15 | 15 | 18 | 9 | 17.5 |

"A" in part number specifies Aluminum material. Specify "B" for Steel and "S" for 304L Stainless Steel. Note: Aluminum not available in 7", 10" and larger. Replacement Components: Series 72 Sight Glass Tubing: PN 73P(Size)-9. Neoprene Garter: "Garter for (Size) Sight Glass." Band Clamp: "Band/Clamp Assembly for (Size) Sight Glass." Series 72 Sight Glass assemblies rated to 15 PSIG and 15 in. Hg. OD sizes 2" thru 6" rated to 240°F. OD sizes 8" and larger rated to 150°F. Metal bar between tubes is static conductor.

#73 REPLACEMENT SIGHT GLASS TUBE



We maintain a large stock of clear plastic tubing in full lengths, or cut to your specifications. Sight glass is priced per inch, plus a standard cutting charge. When ordering, indicate desired length in inches in place of the "X." Replacement tubes for Kice Series 71 and 72 Sight Glass are indicated below. OD sizes 2", 2.5", 3", 3.5", 4", 5" and 6" are Polycarbonate; Other sizes are Acrylic. Other sizes and wall thicknesses are available on special order.

| PART NO. | D (OD) | L | T |
|----------|--------|-----|--------|
| 73P2-X | 2 | 96" | .125" |
| 73P2.5-X | 2.5 | 96" | .125" |
| 73P3-X | 3 | 96" | .125" |
| 73P3.5-X | 3.5 | 96" | .125" |
| 73P4-X | 4 | 96" | .125" |
| 73P4.5-X | 4.5 | 72" | .125" |
| 73P5-X | 5 | 96" | .125" |
| 73P6-X | 6 | 96" | .125" |
| 73P7-X | 7 | 72" | .1875" |
| 73P8-X | 8 | 72" | .1875" |
| 73P10-X | 10 | 72" | .1875" |
| 73P12-X | 12 | 72" | .1875" |
| 73P14-X | 14 | 72" | .1875" |
| 73P15-X | 15 | 72" | .1875" |

L = Full Length

For Series 71 replacement tube, specify PN 73P(Size)-4
For Series 72 replacement tube, specify PN 73P(Size)-9